

J2 TECHNICAL ARTICLE

Number 37

From Octagon Heaven

July 5, 1981

Resource: Colin Tieche
MMM Register Member

TYPE H, SU CARBURETTOR COMPONENTS

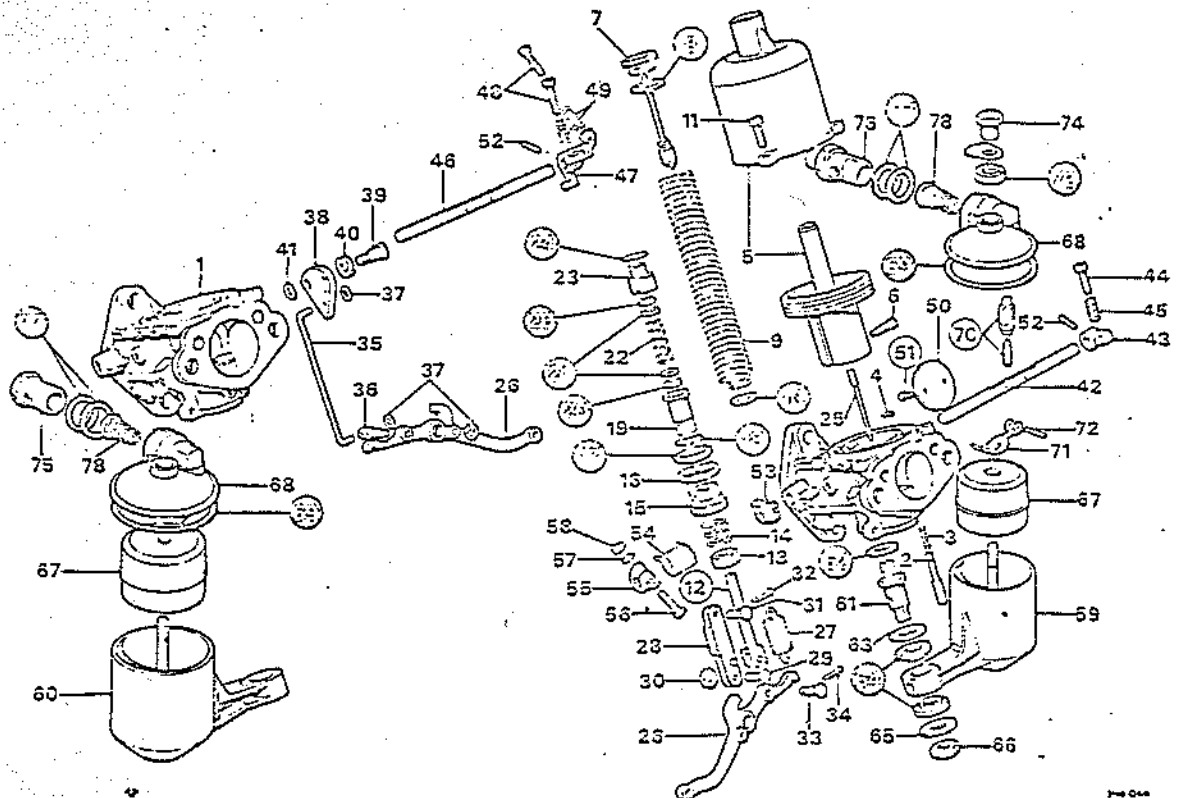

Note: Engine flange and air intake washers included in kit but not illustrated

□ Alternative parts included to cover all specifications
○ Parts included in Gasket Service Kit
○ Parts included in Maintenance Kit
○ Parts included in SU publications AUC 8612 and AUC 9798
Full tuning and servicing instructions are given in SU publications AUC 8612 and AUC 9798

- | | | |
|----------------------------|-----------------------------------|-----------------------------------|
| 1 Body | 29 Link Pin (Lever) | 57 Washer—Bolt |
| 2 Piston Lifting Pin | 30 Washer | 58 Nut for Bolt |
| 3 Spring for Pin | 31 Link Pin (Body) | 59 Float Chamber |
| 4 Circlip | 32 Split Pin | 60 Float Chamber |
| 5 Suction Chamber Assembly | 33 Pin—Lever | 61 Banjo Pillar |
| 6 Needle Screw | 34 Split Pin | □ 62 Washer—Pillar |
| 7 Piston Damper | 35 Tension Link | 63 Washer—Inner |
| 8 Washer—Fibre | 36 Swivel Pin | □ 64 Rubber Grommet |
| 9 Piston Spring | 37 Washer | 65 Washer |
| □ 10 Piston Spring Washer | 38 Cam Plate | 66 Lock Nut |
| 11 Suction Chamber Screw | 39 Pivot Bolt | 67 Float |
| □ 12 Jet Assembly | 40 Washer (Spring) | 68 Float Chamber Lid |
| 13 Adjusting Nut | 41 Washer | □ 69 Float Lid Washer |
| 14 Spring | 42 Throttle Spindle | ○ 70 Needle and Seat Assembly |
| 15 Jet Locking Nut | 43 Throttle Stop Lever | 71 Hinge Lever |
| 16 Sealing Ring | 44 Adjusting Screw | 72 Pin |
| 17 Cork Sealing Ring | 45 Stop Screw Spring | □ 73 Cover Cap |
| 18 Washer—Bottom Bearing | 46 Throttle Spindle | 74 Cap Nut |
| 19 Washer (Wash) | 47 Throttle Stop Lever | 75 Banjo Bolt |
| 20 Washer (Wash) | 48 Adjusting Nut | 76 Union Bolt |
| 21 Spring | 49 Spring—Stop Screw | ○ 77 Bolt Washer |
| 22 Top Bearing | 50 Throttle Disc | 78 Filter |
| 23 Washer (Copper) | □ 51 Throttle Disc Securing Screw | □ 79 Holding-up Bolt Washers |
| 24 Jet Needle | 52 Throttle Stop Lever Pin | □ 80 Serrated Washer |
| 25 Jet Lever | 53 Return Spring Anchor Plate | □ 81 Washer—Aluminium |
| 26 Jet Lever | 54 Return Spring | □ 82 Fibre Washer—Holding-up Bolt |
| 27 Jet Lever Return Spring | 55 Clip | |
| 28 Link Assembly | 56 Bolt for Clip | |