

## J2 TECHNICAL ARTICLE

Number 106

April 22, 1982

From Octagon Heaven

### THE BULK HEAD (FIRE WALL)

In technical article Number 8 it was stated that the Bulk Head was made of 3/8 plywood. Nobody questioned this figure and in fact several said yes, that was correct. Since that time I have examined the old fume seal, the new fume seal, and my obviously original (hardly-hanging-together plywood) bulkhead and have concluded that the original was 1/4" Plywood. Although the extra 1/8" thickness would make a stronger piece, there would be a problem not only fitting on the bonnet fume seal, but also the fume seal of technical article 104, the bottom fume seal.

After very careful layout of my bulk head, I have made a drawing of the unit for making of a new bulk head.

The first drawing locates key dimensions:

(key dimensions for making)

- the radius over the lower draught excluder/lower fume seal.
- the lower corner which fit over the chassis rails.
- the center line up the center of the bulk head.
- the center line for the holes for attaching the bulk head to the bulk head supports.
- the location of the top and bottom 5/16" bolt holes.
- the top edge of the bulk head at the center line.
- the top of the bulk head above the center line of the support holes.
- the outside edge of the bulk head at the top hole.

The second drawing gives some further dimensions of the outside edges. These dimensions I am not really confident in but it will give you some close dimensions. The key is not to fit the bonnet fume seal onto the bulk head until later so that it can be positioned to assure a seal just in case the bulk head is off a little in dimensions. These outside dimensions come off of the main holes for mounting to the bulk head support for which I am comfortable.

The third drawing gives dimensions for:

- the steering column shaft hole
- the rain gutter brkt. holes
- the wire loom hole

Other components will be given position dimensions in later articles.

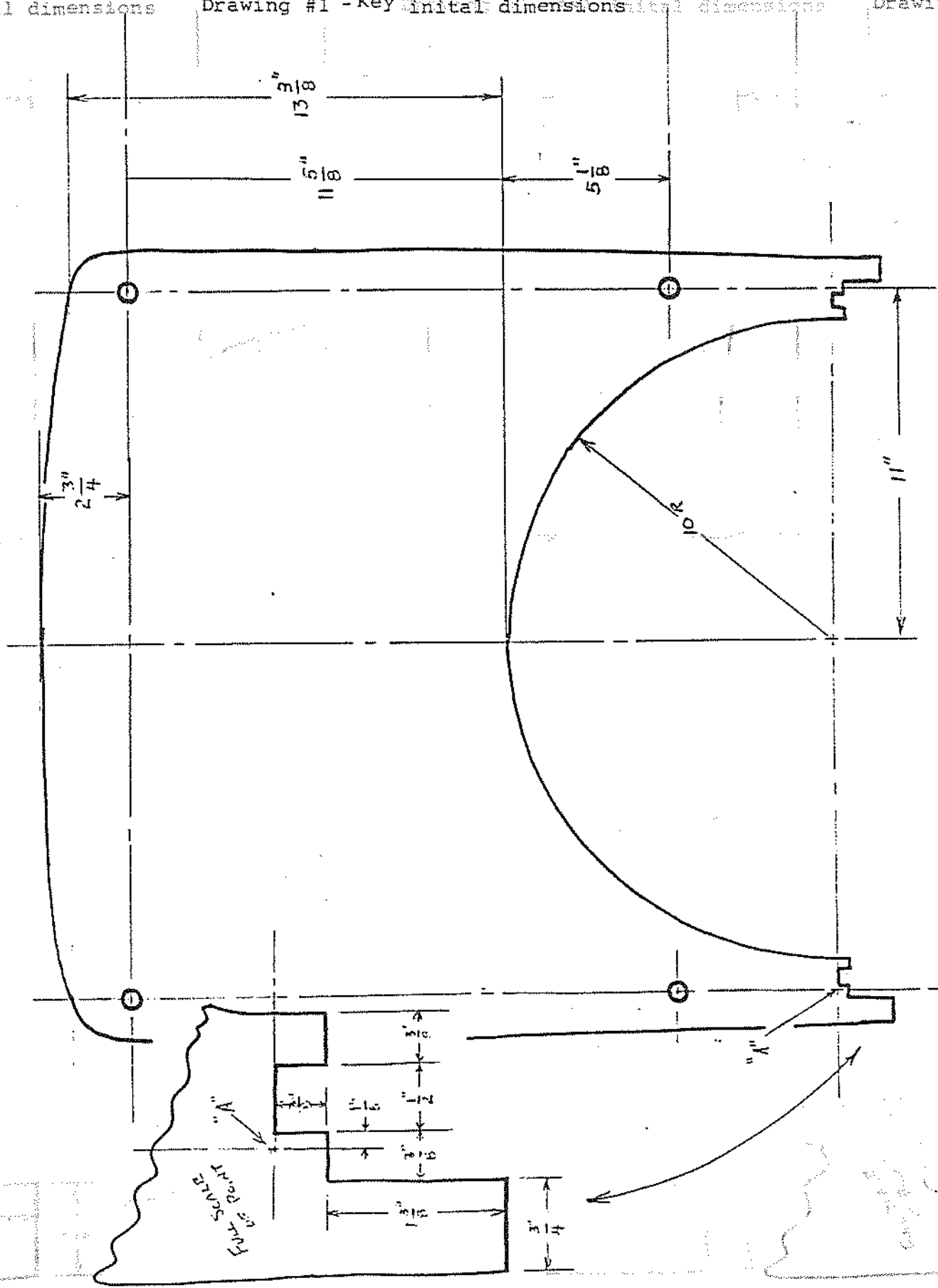

outside "curves"

Drawing # 2 - outside "curves"

175-110

