

THE

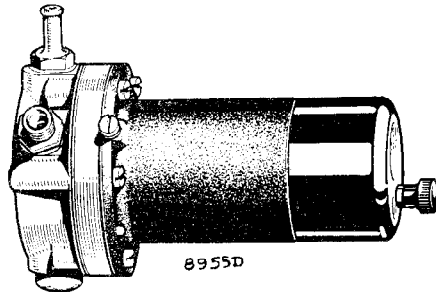

# ELECTRIC FUEL PUMP

(TYPE 'L')



8955D

**AUTHORIZED DISTRIBUTOR :**

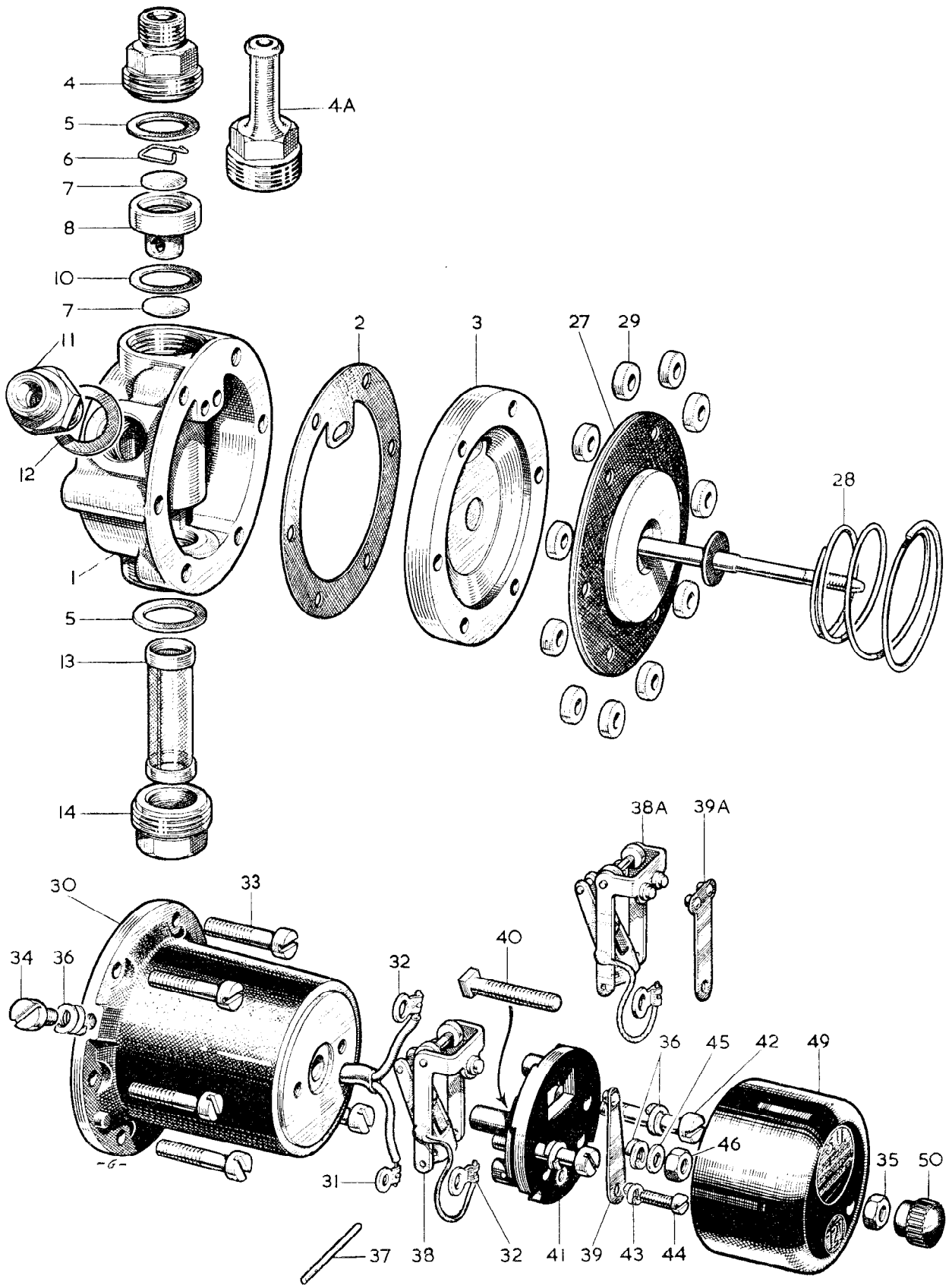

**TYPE 'L' ELECTRIC FUEL PUMP**

**SPECIFICATION Nos. AUA25, AUA26, AUA58, and AUA66**

Illus. No.	Part No.	Qty. off	Description	Illus. No.	Part No.	Qty. off	Description	
	<b>Spec. AUA25</b>	1	<b>Electric fuel pump complete (12-volt basic pump).</b>	37	AUA1435	1	<b>ROCKER AND PEDESTAL GROUP</b> Spindle—contact breaker—inner and outer rocker. Rocker and blade sub-assembly—single contact (Specs. AUA25 and AUA26) including: Terminal tag—2 BA. Spring blade—single contact. Rocker and blade sub-assembly—double contact (Spec. AUA58) including: Terminal tag—2 BA. Spring blade—double contact (Spec. AUA58). Terminal screw—2 BA. Pedestal sub-assembly. Pedestal screw—2 BA. Spring washer—5 BA. Screw—5 BA—spring blade. Lead washer. Terminal nut—2 BA—recessed. End cover — black — 12-volt (Specs. AUA25 and AUA58). End cover — brown — 6-volt (Spec. AUA26). Terminal knob.	
	<b>AUA26</b>	1		<b>Electric fuel pump complete (6-volt).</b>	38	AUA6020		1
	<b>AUA58</b>	1			<b>Electric fuel pump complete (with double contacts).</b>	32		AUA1456
			<b>BODY GROUP</b>	39		AUA6032		1
1	AUA4080	1	Body—aluminium.	38A	AUA6021	1		
2	AUA4082	1	Joint—washer.	32	AUA1456	1		
3	AUA4081	1	Plate—body.	39A	AUA6036	1		
4	AUA1422	1	Outlet union.	40	AUA1468	2		
4A	AUA1244	1	Outlet union (AUA66).	41	AUA6034	1		
5	AUA1442	2	Washer—filter and outlet union.	42	AUA1459	2		
6	AUA840	1	Spring clip—valve.	43	AUA868	1		
7	AUA839	2	Valve disc.	44	AUA847	1		
8	AUA1416	1	Valve cage.	45	AUA1662	1		
10	AUA1479	1	Washer—valve cage.	46	AUA1661	1		
11	AUA887	1	Double-ended inlet union.	49	AUA1466	1		
12	AUA1405	1	Washer—inlet union.		AUA1469	1		
13	AUA1464	1	Filter.	50	†AUA869	1		
14	AUA1421	1	Filter plug.					
			<b>DIAPHRAGM GROUP</b>					
27	AUA6011	1	Diaphragm sub-assembly.					
28	AUA1449	1	Spring—diaphragm.					
29	AUA1433	11	Roller.					
			<b>COIL GROUP</b>					
30	AUA6001	1	Coil housing sub-assembly—12-volt (Spec. AUA25 and AUA58). Terminal tag—5 BA (all Specs.).					
31	AUA1455	1	Terminal tag—2 BA (all Specs.).					
32	AUA1456	1	Coil housing sub-assembly—6-volt (Spec. AUA26).					
30	AUA6000	1	Screw—2 BA—coil housing to body.					
33	AUA4083	6	Earthing stud—long—2 BA.					
34	*AUA4850	1	Terminal nut—2 BA (Specs. AUA25 and AUA26).					
35	*AUA878	1	Terminal nut—2 BA (Spec. AUA58).					
		2	Terminal nut—2 BA (Spec. AUA58).					
36	AUA1863	4	Spring washer—double coil—2 BA.					

\* Earlier pump fitted with earthing stud Part No. AUA4084.  
Use 2 nuts Part No. AUA878 (Spec. Nos. AUA25, AUA26).  
3 nuts Part No. AUA878 (Spec. No. AUA58).

† On Spec. AUA58 terminal nut AUA878 is fitted. Also 1 shake-proof washer, Part No. AUA4643.

**Note.—AUA66.** Minor 1000, commenced at Car No. 476764.  
Minor Traveller, commenced at Car No. 478077.  
Quarter-ton Van, commenced at Car No 53179.

SOLE EXPORTERS

**NUFFIELD EXPORTS LIMITED**

*Proprietors: Morris Motors Limited*

**COWLEY - OXFORD - ENGLAND**

Telephone: OXFORD 77733  
Telex: MOREX, OXFORD  
Telegrams and Cables: MOREX, OXFORD



Codes: BENTLEY'S, BENTLEY'S SECOND  
PHRASE, A.B.C. (5th and 6th EDITIONS),  
WESTERN UNION AND PRIVATE